

1.1 Residential area International

Product profile

Residential construction

Standard version

- Backset 60 mm
- Forend 235x25x3 mm rectangular
- Clamp follower 8 mm
- Forend satin stainless steel
- Lever 2 turns, 2 x 12,5 mm
- Centres 72 mm
- Reversible latch left/right

Cutout

- 1052.0 latch
- 1052.1 lever key
- 1052.4 for bathroom
- 1052.7 profile cylinder
- 1052.03 deadlock
- 1052.07 nightlatch

Options

- Stulp 235 x 20mm, rund
- Forend polished stainless steel
- Forend in satin brass
- Forend polished brass

Packaging

EP single packaging

Quality standard

Firetested by BRE up to 4 hours

Mortice lock 1052 with reversible latch

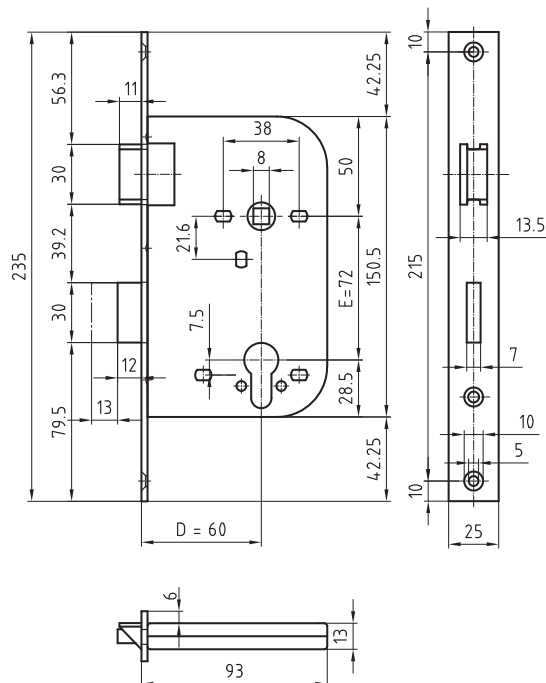
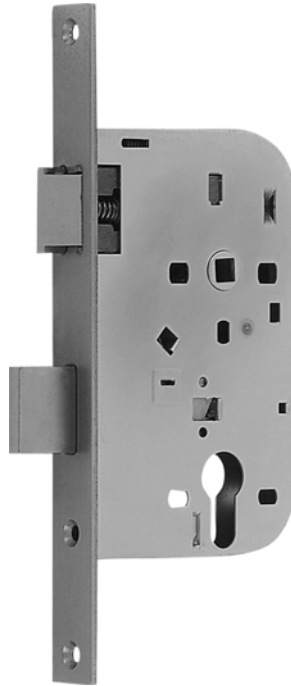

1052.50.DE1.VL
Striking plate



1052.50.DE107.VL
Striking plate



1052.50.DE103.VL
Striking plate



1052.50.DE1
Striking plate



1052.50.DE107
Striking plate